

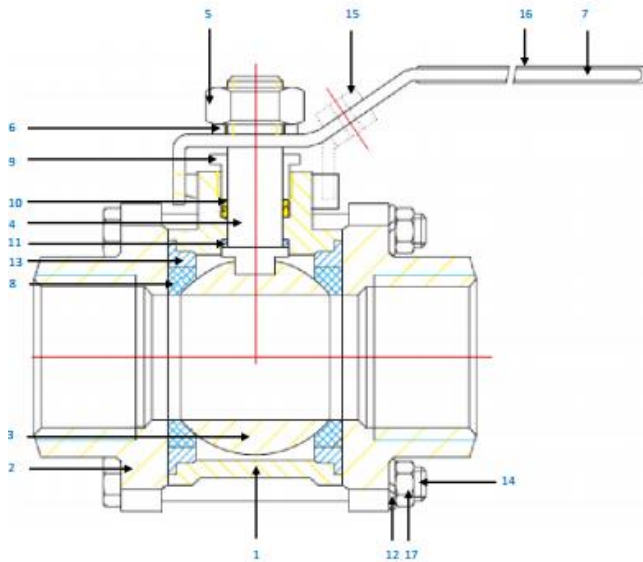

## FEATURES AND BENEFITS

- For Industrial, Chemical & General Applications
- 3 Piece 316 S/S Swing Out design (allows inline maintenance)
- Threaded BSPT Ends
- Full Bore
- Lockable Handle
- Blowout Proof Stem
- Investment Cast Body Construction
- Pressure Rating:
  - 8mm - 50mm 1000PSI
  - 65mm - 100mm 800PSI
- Replacement Seal Kits available
- Available with full 316 S/S components



NO.	PART NAME	MATERIAL	Q'TY
1	Body	CF8M	1
2	End Cap	CF8M	2
3	Ball	SUS 316	1
4	Stem	SUS 316	1
5	Stem Nut	SUS 304	1
6	Stem Washer	SUS 304	1
7	Handle	SUS 304	1
8	Seat	PTFE	2
9	Gland Nut	SUS 304	1
10	V-Ring Packing	PTFE	§
11	Stem Seal	PTFE	1
12	Bolt Washer	SUS 304	‡
13	Joint Gasket	PTFE	2
14	Bolt	SUS 304	*
15	‡ Locking Device	SUS 304	1
16	Handle Sleeve	Vinyl	1
17	Bolt Nut	SUS 304	‡

§ For 1/2" & 3/4" - regular 1 pc stem packing is used  
 For 1/2" & 3/4" - 1 set of v-ring packing consists of 2pcs of v-ring  
 For 4" - 1 set of v-ring packing consists of 3 pcs of v-ring  
 ‡ For 1/2" to 2" - 4pcs of bolts (single end, external thread)  
 \* For 1/2" to 2" - 4pcs of studs (double ends, external thread)  
 For 2 1/2" to 3" - 4pcs of studs (double ends, external thread)  
 For 4" - 6pcs of studs (double ends external thread)

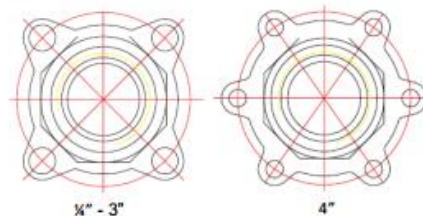
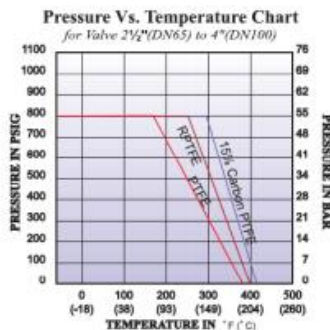
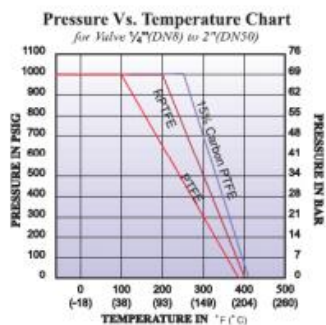

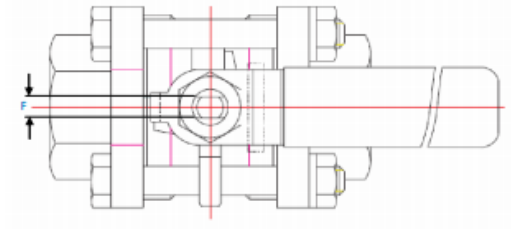
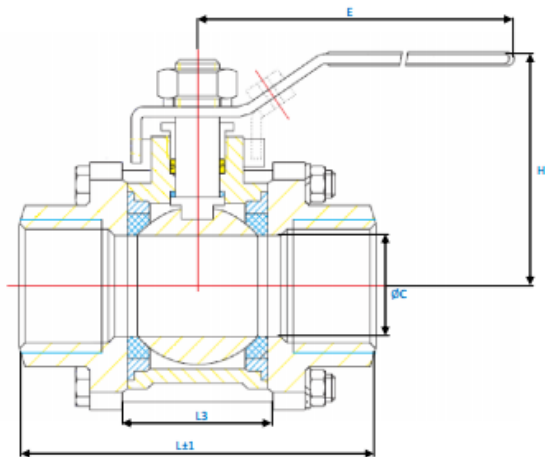

B301 Threaded End  
Thread Standard in BSPT.

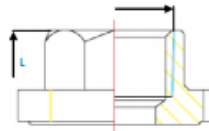

B301 Socket Weld End



#### Dimensions (mm)

SIZE	ØA	ØC	E	F	H	L	L2	L3	W(Kg)
¼"	14	11.6	100	5.0	50	56.6	10	23.6	0.35
⅜"	17.6	12.7	100	5.0	50	56.6	10	23.6	0.33
½"	21.7	15.0	100	6.5	60	65.7	10	23.6	0.56
¾"	27.3	20.0	100	6.5	64	76.2	13	28	0.75
1"	34.1	25.0	165	8.0	71	86.2	13	33.9	1.04
1½"	42.8	32.0	165	8.0	78	102.8	13	42.5	1.74
1½"	48.7	38.0	190	9.7	86	119.4	13	53.2	2.41
2"	61	50.0	190	9.7	95	131.4	16	64.6	3.66
2½"	ANSI 73.5 PN 76.9	65.0	250	12.0	130	164	16	87	7.1
3"	90.0	80.0	250	12.0	148	182.7	16	99	10.5
4"	115.2	100	280	15.0	185	235.6	20	127	20.76