

Stainless Steel press pipe



- Stainless Steel Press fittings
- Type : V & M
- Standard : DIN & JIS & GB

Application

- It can be used in cold and hot water
- Technical building systems, installation industry
- Working pressure : $\leq 1.6\text{MPa}$
- Seal ring made of EPDM, black
- working temperature : -20°C - 130°C

Technical data

- Material : Stainless Steel AISI 304L , AISI 316L

Size (mm)	OD (mm)	Size (Inches)	L (m)	Wall (mm)
12	15	3/8	6	1
15	18	1/2	6	1
20	22	3/4	6	1.2
25	28	1	6	1.2
32	35	1 1/4	6	1.5
40	42	1 1/2	6	1.5
50	54	2	6	1.5
65	76.1	2 1/2	6	1.5
80	88.9	3	6	1.5
100	108	4	6	2

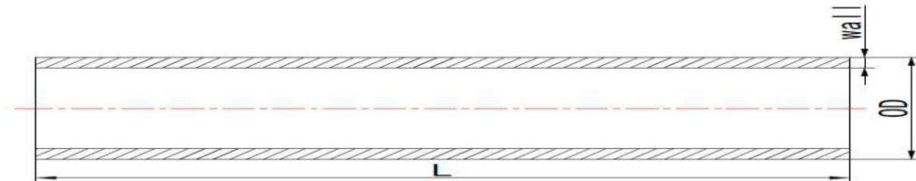

Stainless Steel press coupling



- Stainless Steel Press fittings
- Type : V & M
- Standard : DIN & JIS & GB

Application

- It can be used in cold and hot water
- Technical building systems, installation industry
- Working pressure : $\leq 1.6\text{MPa}$
- Seal ring made of EPDM, black
- working temperature : $-20^{\circ}\text{C} - 130^{\circ}\text{C}$

Technical data

- Material : Stainless Steel AISI 304L , AISI 316L

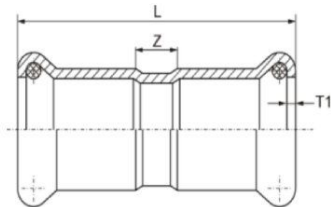

Size (Inches)	OD (mm)	L (mm)	L (mm)	Z (mm)	T1 (mm)
3/8	15	48	53	8	1.5
1/2	18	48	53	8	1.5
3/4	22	50	55	8	1.5
1	28	54	59	8	1.5
1 1/4	35	62	65	10	1.5
1 1/2	42	73	76	11	1.5
2	54	85	82	13	1.5
2 1/2	76.1	142	120	32	2
3	88.9	163	136	37	2
4	108	192	182	38	2
4	114.3	193		51	2
5	139.7	250		54	2
6	168.3	300		64	2

Stainless Steel press Reduce coupling



- Stainless Steel Press fittings
- Type : V & M
- Standard : DIN & JIS & GB

Application

- It can be used in cold and hot water
- Technical building systems, installation industry
- Working pressure : $\leq 1.6\text{MPa}$
- working temperature : $-20^{\circ}\text{C} - 130^{\circ}\text{C}$

Technical data

- Material : Stainless Steel AISI 304L , AISI 316L

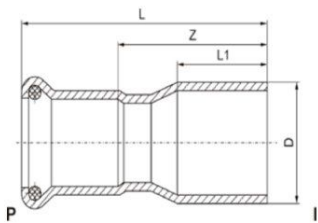

Size (Inches)	OD (mm)	L (mm)	L (mm)	Z (mm)	L1 (mm)
1/2x3/8	18x15	55	60	35	24
3/4x1/2	22x18	61	64	41	24
1x1/2	28x18	69	76	49	26
1x3/4	28x22	60	71	39	26
1 1/4x3/4	35x22	70	86	49	29
1 1/4x1	35x28	67	82	44	29
1 1/2x3/4	42x22	78	95	57	38
1 1/2x1	42x28	82	93	59	38
1 1/2x1 1/4	42x35	80	87	54	38
2x1	54x28	92	112	69	42
2x1 1/4	54x35	95	109	69	42
2x1 1/2	54x42	101.5	108	65.5	42
2 1/2x1 1/2	76.1x42	151		119	
2 1/2x2	76.1x54	140		103	
3x2	88.9x54	156		119	
3x2 1/2	88.9x76.1	156		101	
4x2	108x54	204		167	
4x2 1/2	108x76.1	196		141	
4x3	108x88.9	190		127	

Stainless Steel press Slip coupling



- Stainless Steel Press fittings
- Type : V & M
- Standard : DIN & JIS & GB

Application

- It can be used in cold and hot water
- Technical building systems, installation industry
- Working pressure : $\leq 1.6\text{MPa}$
- Seal ring made of EPDM, black
- working temperature : $-20^{\circ}\text{C} - 130^{\circ}\text{C}$

Technical data

- Material : Stainless Steel AISI 304L 、 AISI 316L

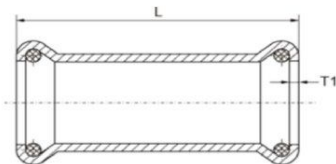

Size (Inches)	OD (mm)	L (mm)	T1 (mm)	T2 (mm)	Weight g
3/8	15	80	1.5	1	72
3/4	22	85	1.5	1.2	113
1	28	95	1.5	1.2	149
1 1/4	35	105	1.5	1.5	234
1 1/2	42	120	1.5	1.5	324
2	54	135	1.5	1.5	468
2 1/2	76.1	230	2		874
3	88.9	258	2		1196
4	108	305	2		1775

Adapter with Female Threaded End



- Stainless Steel Press fittings
- Type : V & M
- Standard : DIN & JIS & GB

Application

- It can be used in cold and hot water
- Technical building systems, installation industry
- Working pressure : $\leq 1.6\text{MPa}$
- Seal ring made of EPDM, black
- working temperature : $-20^{\circ}\text{C} - 130^{\circ}\text{C}$

Technical data

- Material : Stainless Steel AISI 304L 、 AISI 316L

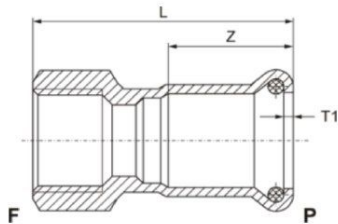

Size (Inches)	OD (mm)	L (mm)	L (mm)	Z (mm)	T1 (mm)
3/8x1/2	15xRp ¹ / ₂	44	49	20	1.5
1/2x1/2	18xRp ¹ / ₂	44	49	20	1.5
1/2x3/4	18xRp ³ / ₄	48	49	20	1.5
3/4x1/2	22xRp ¹ / ₂	45	49	21	1.5
3/4x3/4	22xRp ³ / ₄	49	51	21	1.5
1x1	28xRp1	52	57	23	1.5
1 1/4x1 1/4	35xRp ¹ / ₄	60	64	26	1.5
1 1/2x1 1/2	42xRp ¹ / ₂	58.5	71	31	1.5
2x2	54xRp2	76.5	81	36	1.5
2 1/2x1 1/2	76.1xRp ² / ₂	104		60	2
3x3	88.9xRp3	105		64	2
4x4	108xRp4	142		78	2
4x4	114.3xRp4	142		71.3	2

Stainless Steel press male adaptor



- Stainless Steel Press fittings
- Type : V & M
- Standard : DIN & JIS & GB

Application

- It can be used in cold and hot water
- Technical building systems, installation industry
- Working pressure : ≤ 1.6MPa
- Seal ring made of EPDM, black
- working temperature : -20°C -130°C

Technical data

- Material : Stainless Steel AISI 304L 、 AISI 316L

Size (Inches)	OD (mm)	L (mm)	Z (mm)	T1 (mm)	Weight g
3/8x1/2	15xR ¹ / ₂	51.5	20	1.5	62
1/2x1/2	18xR ¹ / ₂	51.5	20	1.5	65

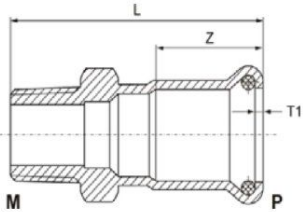

1/2x3/4	18xR3/4	58.5	20	1.5	71
3/4x1/2	22xR1/2	52.5	21	1.5	75
3/4x3/4	22xR3/4	59.5	21	1.5	101
1x1	28xR1	69.5	23	1.5	143
1 1/4x1 1/4	35xR1 1/4	79	26	1.5	205
1 1/2x1 1/2	42xR1 1/2	88	31	1.5	268
2x2	54xR2	101.6	36	1.5	457
2 1/2x1 1/2	76.1xR2 1/2	125	70	2	820
3x3	88.9xR3	138	75	2	1158
4x4	108xR4	142	78	2	1815
4x4	114.3xR4	142	71.3	2	1980

Stainless Steel press female adaptor with union nut



- Stainless Steel Press fittings
- Type : V & M
- Standard : DIN & JIS & GB

Application

- It can be used in cold and hot water
- Technical building systems, installation industry
- Working pressure : $\leq 1.6\text{MPa}$
- Seal ring made of EPDM, black
- working temperature : $-20^{\circ}\text{C} - 130^{\circ}\text{C}$

Technical data

- Material : Stainless Steel AISI 304L , AISI 316L

Size (Inches)	OD (mm)	L (mm)	Z (mm)	T1 (mm)	Weight g
3/8x1/2	15xG1/2	62.5	16		57
1/2x1/2	18xG1/2	62.5	16		68
1/2x3/4	18xG3/4	64.5	18		73

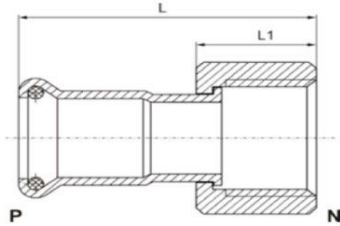

3/4x1/2	22xG ¹ / ₂	62.5	16		70
3/4x3/4	22xG ³ / ₄	64	18		73
3/4x1	22x G1	69	20		116
1x1	28xG1	70.5	20		125
1 1/4x1 1/4	35xG1 ¹ / ₄	80	24		206
1 1/2x1 1/2	42xG1 ¹ / ₂	85.5	24		321
2x2	54xG2	98.5	27		436

Stainless Steel press 90° elbow



- Stainless Steel Press fittings
- Type : V & M
- Standard : DIN & JIS & GB

Application

- It can be used in cold and hot water
- Technical building systems, installation industry
- Working pressure : ≤ 1.6MPa
- Seal ring made of EPDM, black
- working temperature :-20°C -130°C

Technical data

- Material : Stainless Steel AISI 304L 、 AISI 316L

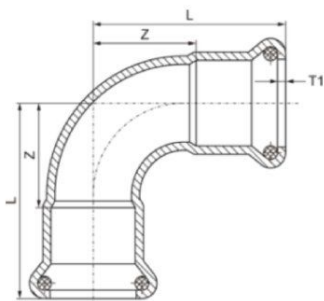

Size (Inches)	OD (mm)	L (mm)	Z (mm)	T1 (mm)	Weight g
3/8	15	41	21	1.5	55
1/2	18	44	24	1.5	67
3/4	22	50	29	1.5	94
1	28	61	38	1.5	141
1 1/4	35	73	47	1.5	205
1 1/2	42	88	57	1.5	301
2	54	106	70	1.5	482
2 1/2	76.1	150	95	2	977

3	88.9	174	111	2	1325
4	108	215	138	2	2091
4	114.3	250	177	2	2537
5	139.7	314	217	2	3813
6	168.3	378	261	2	5651

Stainless Steel press elbow 90° with Plain End



- Stainless Steel Press fittings
- Type : V & M
- Standard : DIN & JIS & GB

Application

- It can be used in cold and hot water
- Technical building systems, installation industry
- Working pressure : $\leq 1.6\text{MPa}$
- Seal ring made of EPDM, black
- working temperature : $-20^{\circ}\text{C} - 130^{\circ}\text{C}$

Technical data

- Material : Stainless Steel AISI 304L , AISI 316L

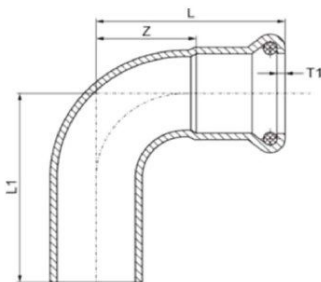

Size (Inches)	OD (mm)	L (mm)	L (mm)	Z (mm)	L1 (mm)
3/8	15	41	40	21	42
1/2	18	44	45	24	46
3/4	22	50	49.5	29	52
1	28	61	59.5	38	60
1 1/4	35	73	71.5	47	70
1 1/2	42	88	84.5	57	89
2	54	106	104.5	70	107
2 1/2	76.1	150	140	95	200
3	88.9	174	160	111	200
4	108	215	221	138	200
4	114.3	250		177	200
5	139.7	314		217	200
6	168.3	158		261	200

Stainless Steel press elbow 45°



- Stainless Steel Press fittings
- Type : V & M
- Standard : DIN & JIS & GB

Application

- It can be used in cold and hot water
- Technical building systems, installation industry
- Working pressure : $\leq 1.6\text{MPa}$
- Seal ring made of EPDM, black
- working temperature : $-20^{\circ}\text{C} - 130^{\circ}\text{C}$

Technical data

- Material : Stainless Steel AISI 304L 、 AISI 316L

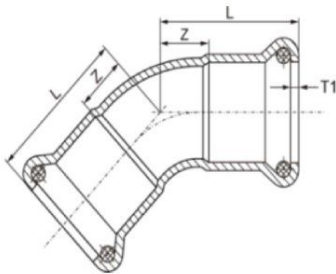

Size (Inches)	OD (mm)	L (mm)	Z (mm)	T1 (mm)	Weight g
3/8	15	30	10	1.5	50
1/2	18	31	11	1.5	60
3/4	22	34	13	1.5	80
1	28	40	17	1.5	116
1 1/4	35	47	21	1.5	161
1 1/2	42	56	25	1.5	236
2	54	67	31	1.5	366
2 1/2	76.1	98	43	2	773
3	88.9	112	49	2	991
4	108	138	61	2	1600
4	114.3	159	89	2	1268
5	139.7	204	105	2	1906
6	168.3	245	126	2	2825

Stainless Steel press elbow 45° with Plain End



- Stainless Steel Press fittings
- Type : V & M
- Standard : DIN & JIS & GB

Application

- It can be used in cold and hot water
- Technical building systems, installation industry
- Working pressure : $\leq 1.6\text{MPa}$
- Seal ring made of EPDM, black
- working temperature : -20°C - 130°C

Technical data

- Material : Stainless Steel AISI 304L , AISI 316L

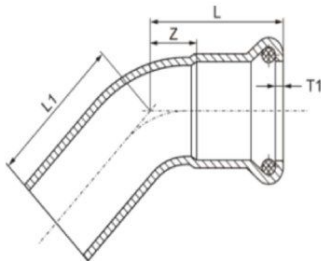

Size (Inches)	OD (mm)	L (mm)	L (mm)	Z (mm)	L1 (mm)
3/8	15	30	29	10	32
1/2	18	31	30	11	33
3/4	22	34	34	13	36
1	28	40	39	17	40
1 1/4	35	47	46	21	46
1 1/2	42	56	54	25	59
2	54	67	65	31	69
2 1/2	76.1	98	93	43	117
3	88.9	112	106	49	131
4	108	138	145	61	154

Stainless Steel press elbow 90° with female threaded End

- Stainless Steel Press fittings
- Type : V & M
- Standard : DIN & JIS & GB



Application

- It can be used in cold and hot water
- Technical building systems, installation industry
- Working pressure : $\leq 1.6\text{MPa}$
- Seal ring made of EPDM, black
- working temperature : $-20^{\circ}\text{C} - 130^{\circ}\text{C}$

Technical data

- Material : Stainless Steel AISI 304L 、 AISI 316L

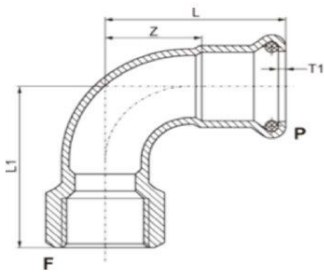

Size (Inches)	OD (mm)	L (mm)	Z (mm)	L1 (mm)	Weight g
3/8x1/2	15xRp1/2	41	21	40	54
1/2x1/2	18xRp1/2	44	24	43	60
1/2x3/4	18xRp3/4	44	24	47	74
3/4x3/4	22xRp3/4	50	29	52	92
1x1	28xRp1	61	38	62	145
1 1/4x1 1/4	35xRp1 1/4	73	47	75	195
1 1/2x1 1/2	42xRp1 1/2	88	57	83	267
2x2	54xRp2	106	70	103	443

Stainless Steel press elbow 90° with male threaded end



- Stainless Steel Press fittings
- Type : V & M
- Standard : DIN & JIS & GB

Application

- It can be used in cold and hot water
- Technical building systems, installation industry
- Working pressure : $\leq 1.6\text{MPa}$
- Seal ring made of EPDM, black
- working temperature : $-20^{\circ}\text{C} - 130^{\circ}\text{C}$

Technical data

- Material : Stainless Steel AISI 304L 、 AISI 316L

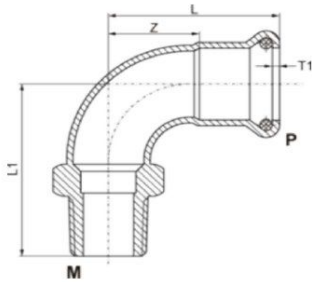

Size (Inches)	OD (mm)	L (mm)	Z (mm)	L1 (mm)	Weight g
3/8x1/2	15xR1/2	41	21	40	70
1/2x1/2	18xR1/2	44	24	43	76
3/4x3/4	22xR3/4	50	29	52	118
1x1	28xR1	61	38	62	173
1 1/4x1 1/4	35xR1 1/4	73	47	75	254
1 1/2x1 1/2	42xR1 1/2	88	57	83	334
2x2	54xR2	106	70	103	582

Stainless Steel press Short elbow 90° with female threaded end



- Stainless Steel Press fittings
- Type : V & M
- Standard : DIN & JIS & GB

Application

- It can be used in cold and hot water
- Technical building systems, installation industry
- Working pressure : ≤ 1.6 MPa
- Seal ring made of EPDM, black
- working temperature : -20°C -130°C

Technical data

- Material : Stainless Steel AISI 304L 、 AISI 316L

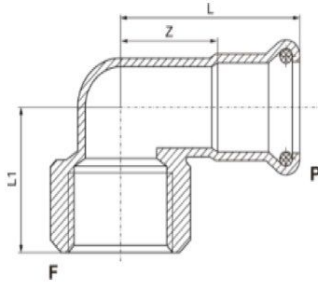

Size (Inches)	OD (mm)	L (mm)	Z (mm)	L1 (mm)	Weight g
3/8x1/2	15xRp ¹ / ₂	46	21	30	92
1/2x1/2	18xRp ¹ / ₂	48	21	30	95
3/4x1/2	22xRp ¹ / ₂	49	21	30	105
3/4x3/4	22xRp ³ / ₄	57.5	29.5	36	151

Stainless Steel press elbow 90° with Wall Plate



- Stainless Steel Press fittings
- Type : V & M
- Standard : DIN & JIS & GB

Application

- It can be used in cold and hot water
- Technical building systems, installation industry
- Working pressure : ≤ 1.6MPa
- Seal ring made of EPDM, black
- working temperature :-20°C -130°C

Technical data

- Material : Stainless Steel AISI 304L 、 AISI 316L

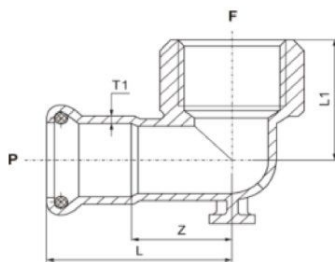

Size (Inches)	OD (mm)	L (mm)	Z (mm)	L1 (mm)	Weight g
3/8x1/2	15xRp ¹ / ₂	46	21	30	99
1/2x1/2	18xRp ¹ / ₂	48	21	30	106
3/4x1/2	22xRp ¹ / ₂	49	21	30	112
3/4x3/4	22xRp ³ / ₄	57.5	29.5	36	186

Stainless Steel press Tee



- Stainless Steel Press fittings
- Type : V & M
- Standard : DIN & JIS & GB

Application

- It can be used in cold and hot water
- Technical building systems, installation industry
- Working pressure : $\leq 1.6\text{MPa}$
- Seal ring made of EPDM, black
- working temperature : $-20^{\circ}\text{C} - 130^{\circ}\text{C}$

Technical data

- Material : Stainless Steel AISI 304L , AISI 316L

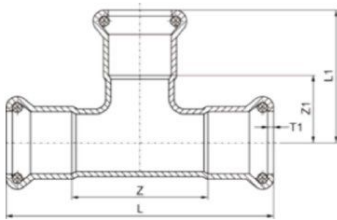

Size (Inches)	OD (mm)	L (mm)	Z (mm)	L1 (mm)	Weight g
3/8	15	68	28	34	83
1/2	18	70	30	35	102
3/4	22	79	37	39.5	130
1	28	92	46	46	173
1 1/4	35	106	54	53	221
1 1/2	42	124	62	62	326
2	54	146	74	73	463
2 1/2	76.1	232	110	115	1192
3	88.9	262	126	127	1617
4	108	312	154	155	2450

Stainless Steel press Reduce Tee



- Stainless Steel Press fittings
- Type : V & M
- Standard : DIN & JIS & GB

Application

- It can be used in cold and hot water
- Technical building systems, installation industry
- Working pressure : $\leq 1.6\text{MPa}$
- Seal ring made of EPDM, black
- working temperature : $-20^{\circ}\text{C} - 130^{\circ}\text{C}$

Technical data

- Material : Stainless Steel AISI 304L 、 AISI 316L

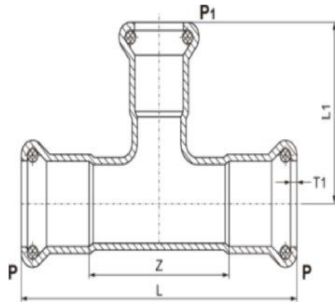

Size (Inches)	OD (mm)	L (mm)	Z (mm)	L1 (mm)	Weight g
1/2x3/8x1/2	18x15	70	30	35	97
3/4x3/8x3/4	22x15	79	37	36	119
3/4x1/2x3/4	22x18	79	37	37.5	125
1x3/8x1	28x15	92	46	38	151
1x1/2x1	28x18	92	46	39.5	158
1x3/4x1	28x22	92	46	41.5	163
1 1/4x3/4x1	35x22	106	54	45.5	198
1 1/4x1x1 1/4	35x28	106	54	48.5	208
1 1/2x3/4x1 1/2	42x22	124	62	51	272
1 1/2x1x1 1/2	42x28	124	62	54	282
1 1/2x1 1/4x1 1/2	42x35	124	62	57.5	295
2x3/4x2	54x22	146	74	57	377
2x1x2	54x28	146	74	60	388
2x1 1/4x2	54x35	146	74	63.5	401
2x1 1/2x2	54x42	146	74	67	432
2 1/2x3/4x2 1/2	76.1x22	232	110	68	942
2 1/2x1x2 1/2	76.1x28	232	110	71	956
2 1/2x1 1/4x2 1/2	76.1x35	232	110	75	968
2 1/2x1 1/2x2 1/2	76.1x42	232	110	79	981
2 1/2x2x2 1/2	76.1x54	232	110	80	1067
3x3/4x3	88.9x22	262	126	76	1256

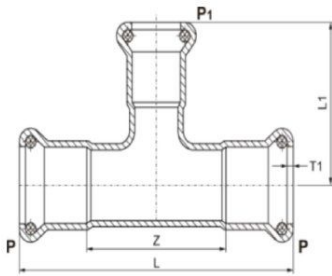

3x1x3	88.9x28	262	126	76	1244
3x1 1/4x3	88.9x35	262	126	83	1267
3x1 1/2x3	88.9x42	262	126	85	1271
3x2x3	88.9x54	262	126	93	1297
3x2 1/2x3	88.9x76.1	262	126	116	1479
4x3/4x4	108x22	312	154	85	1919
4x1x4	108x28	312	154	88	1939
4x1 1/4x4	108x35	312	154	94	1955
4x1 1/2x4	108x42	312	154	96	1886
4x2x4	108x54	312	154	102	1967
4x2 1/2x4	108x76.1	312	154	125	2147
4x3x4	108x88.9	312	154	135	2255

Stainless Steel press Tee with threaded end



- Stainless Steel Press fittings
- Type : V & M
- Standard : DIN & JIS & GB

Application

- It can be used in cold and hot water
- Technical building systems, installation industry
- Working pressure : $\leq 1.6\text{MPa}$
- Seal ring made of EPDM, black
- working temperature : $-20^{\circ}\text{C} - 130^{\circ}\text{C}$

Technical data

- Material : Stainless Steel AISI 304L 、 AISI 316L

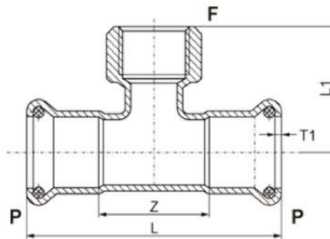

Size (Inches)	OD (mm)	L (mm)	Z (mm)	L1 (mm)	Weight g
3/8x1/2x3/8	15xRp1/2	68	28	33	98
1/2x1/2x1/2	18xRp1/2	70	30	34.5	103
3/4x1/2x3/4	22xRp1/2	79	37	36.5	126
3/4x3/4x3/4	22xRp3/4	79	37	40.5	144
1x1/2x1	28xRp1/2	92	46	39.5	159
1x3/4x1	28xRp3/4	92	46	43.5	177
1x1x1	28xRp1	92	46	44.5	207
1 1/4x1/2x1 1/4	35xRp1/2	106	54	43	194
1 1/4x3/4x1 1/4	35xRp3/4				
1 1/4x1 1/4x1 1/4	35xRp1 1/4	106	54	52	260
1 1/2x1/2x1 1/2	42xRp1/2				
1 1/2x3/4x1 1/2	42xRp3/4				
1 1/2x1 1/4x1 1/2	42xRp1 1/4	124	62	56.5	334
2x1/2x2	54xRp1/2				
2x3/4	54xRp3/4				
2x1 1/2x2	54xRp1 1/2	146	74	60.5	463
2x2x2	54xRp2	146	74	67.5	549
2 1/2x3/4x2 1/2	76.1xRp3/4	232	110	68	1009
2 1/2x2x2 1/2	76.1xRp2	232	110	81	1194
3x3/4x3	88.9xRp3/4	262	126	87	1210
3x2x3	88.9xRp2	262	126	88	1450
4x3/4x4	108xRp3/4	312	154	86	1956
4x2x4	108xRp2	312	154	98	2118

Stainless Steel press Tee with male threaded end



- Stainless Steel Press fittings
- Type : V & M
- Standard : DIN & JIS & GB

Application

- It can be used in cold and hot water
- Technical building systems, installation industry
- Working pressure : $\leq 1.6\text{MPa}$
- Seal ring made of EPDM, black
- working temperature : $-20^{\circ}\text{C} - 130^{\circ}\text{C}$

Technical data

- Material : Stainless Steel AISI 304L 、 AISI 316L

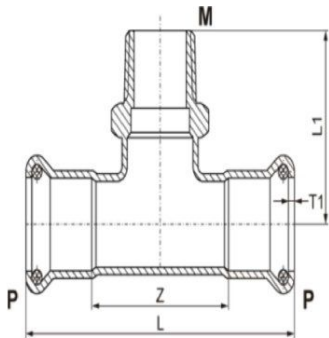

Size (Inches)	OD (mm)	L (mm)	Z (mm)	L1 (mm)	Weight g
3/4x1/2x3/4	22xR1/2	79	37	44	141
3/4x3/4x3/4	22xR3/4	79	37	51	171
1x1/2x1	28xR1/2	92	46	47	174
1x3/4x1	28xR3/4	92	46	54	204
1x1x1	28xR1	92	46	62	235
1 1/4x1/2x1 1/4	35xR1/2	106	54	50.5	307
1 1/4x1 1/4x1 1/4	35xR1 1/4	106	54	71	319
1 1/2x1 1/4x1 1/2	42xR1 1/4	124	62	72	393
2x1 1/2x2	54xR1 1/2	146	74	85	531
2x2x2	54xR2	146	74	92.6	688

Stainless Steel press Bridge Pipe



- Stainless Steel Press fittings
- Type : V & M
- Standard : DIN & JIS & GB

Application

- It can be used in cold and hot water
- Technical building systems, installation industry
- Working pressure : $\leq 1.6\text{MPa}$
- Seal ring made of EPDM, black
- working temperature : $-20^{\circ}\text{C} - 130^{\circ}\text{C}$

Technical data

- Material : Stainless Steel AISI 304L , AISI 316L

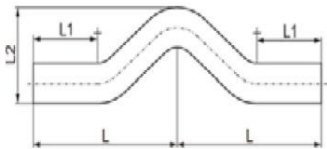

Size (Inches)	OD (mm)	L (mm)	Z (mm)	L2 (mm)	Weight g
1/2	18	117	37	44	181
3/4	22	128	41	53	242
1	28	142	48	64	378

Stainless Steel press Cap



- Stainless Steel Press fittings
- Type : V & M
- Standard : DIN & JIS & GB

Application



- It can be used in cold and hot water
- Technical building systems, installation industry
- Working pressure : $\leq 1.6\text{MPa}$
- Seal ring made of EPDM, black
- working temperature : $-20^{\circ}\text{C} - 130^{\circ}\text{C}$

Technical data

- Material : Stainless Steel AISI 304L 、 AISI 316L

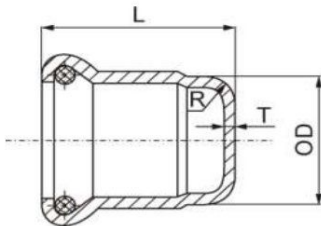

Size (Inches)	OD (mm)	L (mm)	R (mm)	T1 (mm)	Weight g
3/8	15	32	3	1.5	26
1/2	18	32	3	1.5	31
3/4	22	35	5	1.5	40
1	28	37	5	1.5	50
1 1/4	35	43	6	1.5	79
1 1/2	42	48.5	6	1.5	109
2	54	56.5	6	1.5	152
2 1/2	76.1	97		2	457
3	88.9	107		2	586
4	108	128		2	850

Stainless Steel press Adaptor with union nut male threaded end



- Stainless Steel Press fittings
- Type : V & M
- Standard : DIN & JIS & GB

Application

- It can be used in cold and hot water
- Technical building systems, installation industry
- Working pressure : $\leq 1.6\text{MPa}$
- Seal ring made of EPDM, black
- working temperature : $-20^{\circ}\text{C} - 130^{\circ}\text{C}$

Technical data

- Material : Stainless Steel AISI 304L 、 AISI 316L

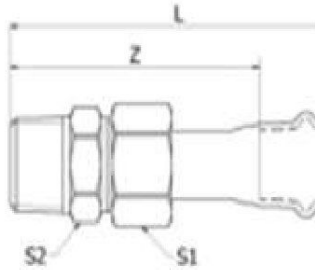

Size (Inches)	OD (mm)	L (mm)	Z (mm)	T1 (mm)	Weight g
3/8x1/2	15x ¹ / ₂				
1/2x1/2	18x ¹ / ₂				
3/4x3/4	22x ³ / ₄				
1x1	28x1				
1 1/4x1 1/4	35x ¹ / ₄				
1 1/2x1 1/2	42x ¹ / ₂				
2x2	54x2				

Stainless Steel press Adaptor with flange



- Stainless Steel Press fittings
- Type : V & M
- Standard : DIN & JIS & GB

Application

- It can be used in cold and hot water
- Technical building systems, installation industry
- Working pressure : $\leq 1.6\text{MPa}$
- Seal ring made of EPDM, black
- working temperature : $-20^{\circ}\text{C} - 130^{\circ}\text{C}$

Technical data

- Material : Stainless Steel AISI 304L 、 AISI 316L

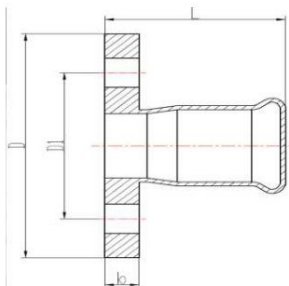

Size (Inches)	OD (mm)	L (mm)	D (mm)	D1 (mm)	Weight g
3/8	15	95	65	53	14
1/2	18	105	75	56	16
3/4	22	115	85	56	16
1	28	140	100	74	18
1 1/4	35	150	110	83	18
1 1/2	42	160	125	87	20
2	54	185	145	100	20
2 1/2	76.1	185	145	114	20
3	88.9	200	160	130	20
4	108	220	180	148	22